

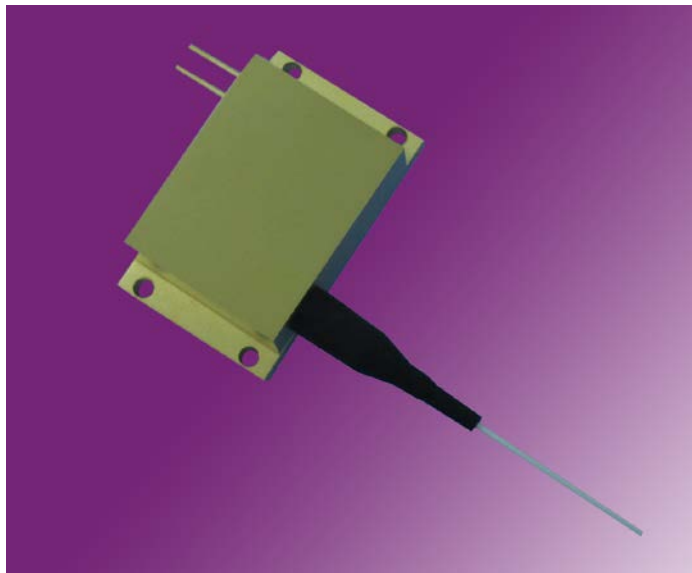

T-Series High Power Laser Diode Module

M9XX±10-35-F105/15-T4S

M9XX±10-40-F105/22-T4S



Features:

- High output Power: 35W, 40W
- 105µm core multimode optical fiber
- 0.15NA,0.22NA
- Fiber laser feedback protection
- 915nm, 940nm and other 9XX wavelength
- Electrically isolated housing

Applications:

- Laser pumping
- Medical use
- Material processing

915nm Characteristics (25°C, 35W)

— P-I Curve
 - - - V-I Curve

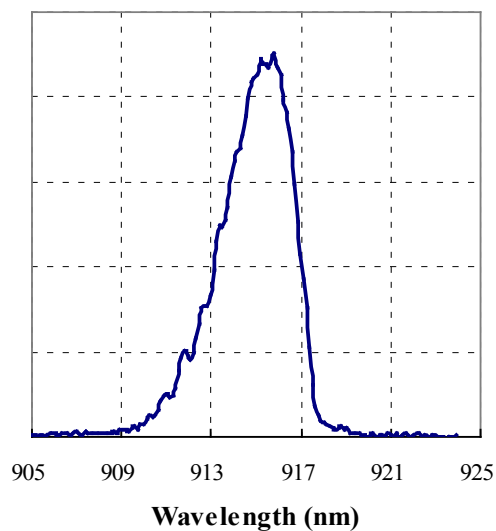
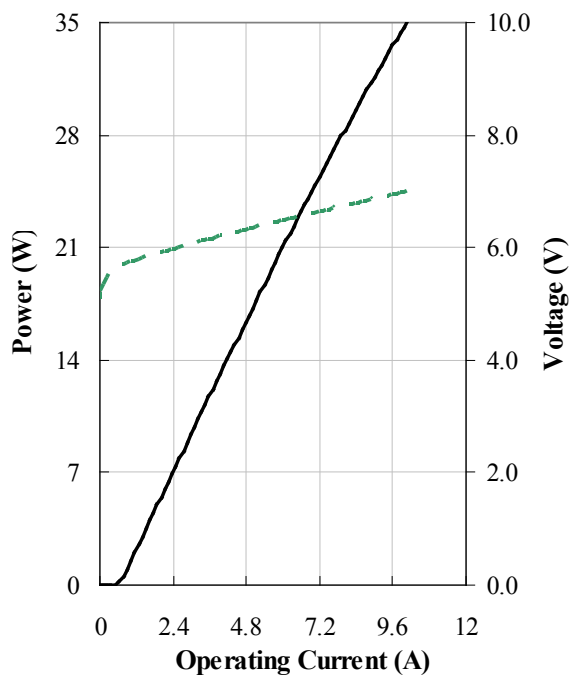

Typical Device Performance (25°C)

Parameter	Symbol	Typical		Unit	
		M9XX±10-35-F105/15-T4S	M9XX±10-40-F105/22-T4S		
Optical	CW Output Power	P_{op}	35	40	W
	Center Wavelength	λ_c	915, 940 and other 9XX wavelength, ±10		nm
	Spectral Width (90% of Power)	$\Delta\lambda$	<6.0		nm
	Wavelength Shift with Temperature	$\Delta\lambda/\Delta T$	0.35		nm/°C
	Feedback Protection (1030-1100nm)	FP	>40		dB
Electrical	Threshold Current	I_{th}	0.65		A
	Operating Current	I_{op}	10.5	12	A
	Operating Voltage	V_{op}	6.8	6.9	V
	Slope Efficiency	η_{es}	3.6		W / A
	Power Conversion Efficiency	η_{ep}	48		%
Fiber	Fiber Core Diameter	d_{core}	105		μm
	Fiber Cladding Diameter	d_{clad}	125		μm
	Fiber Buffer Diameter	d_{buffer}	250		μm
	Numerical Aperture	NA	0.15	0.22	-
	Fiber Length	L	1.0		m

Other Parameters

Parameter	Operating Temperature /°C	Operating Relative Humidity /%	Storage Temperature /°C	Storage Relative Humidity /%	Lead Soldering Temperature, 10s max/°C
Min	10	-	-20	-	-
Max	40	75	80	90	250

Package Dimensions (mm)

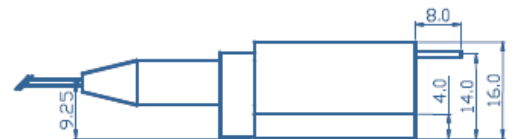
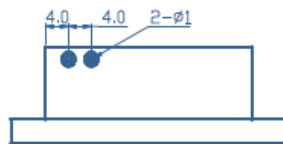

Pin	Function
1	Laser(+)
2	Laser(-)

