

SEC Gas Sensor

HYDROGEN SULFIDE 2000 HL 4S

Technical Specification

Sensor Type	H ₂ S 2000 HL Sensor 4S
Detectable Gases	Hydrogen Sulfide
PN single sensor	01-04-20-03
Measuring Principle	Amperometric 3-electrode sensor
Contact	3 gold pins * non solderable
Standard Range	0 – 2000 ppm
Lower Detectable Limit (LDL)	1 ppm
Maximum Range	5000 ppm
MAK/TLV	10 ppm
Long Term Sensitivity Drift	< 1 % / month
Linearity at standard range	linear
Repeatability	> 98 % of signal
Zero current at normal conditions	+/- 20 nA
Sensitivity	10 ... 30 nA/ppm
Response time at target level	
T50	< 10 s
T90	< 30 s
Sensor warm up time typically	60 s
Operating conditions	- 20°C ... +60°C 10 ... 95 % r. h.
Expected sensor life time	3 years



HYDROGEN SULFIDE 2000 HS 4S

Dimensional Drawing

Sensor dimensions 6,5 mm x 11,4 mm x 14,4 mm ± 0,15 mm tolerance

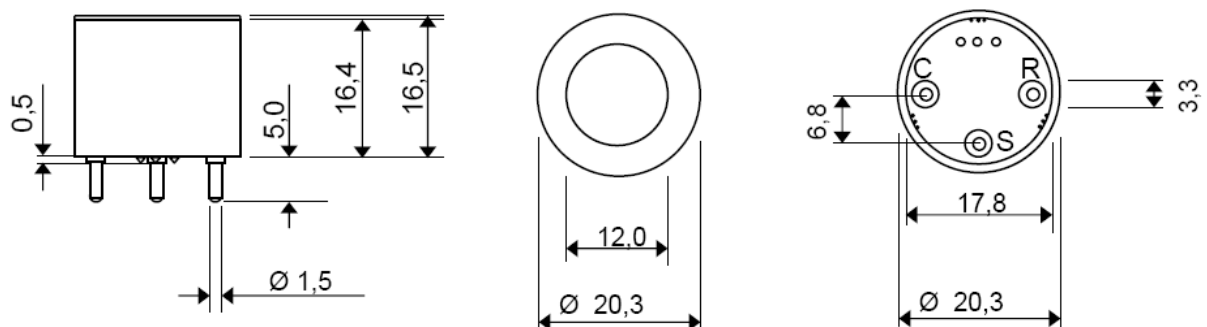

* Soldering to the pins will damage the sensor

SEC Gas Sensor**HYDROGEN SULFIDE 2000 HS 4S****Temperature Dependency**

3%/°C (October 2010)

Will be updated soon

HYDROGEN SULFIDE 2000 HS 4S**Cross Sensitivity**

<i>Gas</i>	<i>Formula</i>	<i>Test Gas Concentration</i>	<i>Reading in ppm</i>
Ammonia	NH ₃	25 ppm	0
Carbon Dioxide	CO ₂	5000 ppm	0
Carbon Monoxide	CO	50 ppm	3
Chlorine	Cl ₂	1.0 ppm	n/a
Hydrocarbons unsaturated	-	1 %	0
Hydrogen	H ₂	100 ppm	3
Isopropanol	C ₃ H ₇ OH	1000 ppm	0
Nitric Oxide	NO	20 ppm	?
Nitrogen Dioxide	NO ₂	10 ppm	-2
Ozone	O ₃	0.5 ppm	n/a
Sulphur Dioxide	SO ₂	20 ppm	n/a

Note:

Test conditions at 20°C/ 1013 hPa, Flow Rate > 500 qcm/min
 Cross sensitivity gases are not target gases. Relation can change with aging.

SolidSense GmbH believes the data contained herein are factual, and the opinions expressed are of qualified experts regarding the results of tests conducted, the data are not to be taken as warranty or representation which SolidSense assumes legal responsibility. The data are offered solely for consideration, investigation, and verification. Any use of these data and information must be determined by the user to be in accordance with federal, state, and local laws and regulations. Specifications are subject to change without notice.

SolidSense GmbH - Felix-Wankel-Str. 5 - 82152 Krailling, Germany

Tel: +49 89 893 255 21 – Fax: +49 89 850 9374 – info@solidSense.de – www.solidSense.de